

# AutoDome 200 Series PTZ Camera System

www.boschsecurity.com



**BOSCH**  
Invented for life



- ▶ Economical, high-speed PTZ dome
- ▶ Fully interchangeable CPUs, cameras, housings, communications, and mounts
- ▶ 18x color camera
- ▶ Optional hybrid operation provides simultaneous analog (coax) and IP connectivity
- ▶ UTP transmission standard on all analog models

Bosch's AutoDome modular camera system is a revolutionary new concept in dome cameras. More than just a series of cameras, it's a dome platform built around a system of intelligent, interchangeable modules that allow you to update camera functionality quickly and cost-effectively. Using common components lets you install a basic camera system today and migrate to a more advanced version tomorrow – without having to replace the entire dome, thus protecting your initial investment.

#### **Interchangeable modules**

The entire AutoDome system is based on five interchangeable modules: the CPU, camera, housing, communications, and power supply. Simply swap one of AutoDome's interchangeable modules and quickly upgrade from analog to IP, color to day/night, or add motion tracking. Never before have you had the ability to adapt a security system to your changing needs this quickly or inexpensively.

By using the same housing components, all installations have a consistent look, and observers have no idea which type of camera (if any) is watching over them. This unique, modular design also gives you the flexibility to move cameras between different

housings when special coverage is needed, or as site plan requirements change. For example, an 18x PTZ camera over a specific area could easily be “hot-swapped” to a 26x day/night without removing the power.

Migrating from a basic dome to one with advanced features such as AutoTrack II intelligent tracking can be done quickly and easily, without requiring dome removal or rewiring. AutoDome's Ethernet communications module allows you to add IP functionality while maintaining connectivity to existing analog inputs and outputs.

#### **200 Series highlights**

The AutoDome 200 Series is an economical, high-speed dome camera that uses a high-performance, 18x color PTZ camera. The 200 Series supports a variety of standard and optional video and data transmission methods, including Bilinx (over coax and UTP), fiber, and even TCP/IP over Ethernet. Remote control, configuration, and firmware updates can also be performed over these cables, offering you unparalleled control of your cameras.

The optional IP Communications Module has hybrid functionality to protect your current analog technology investment while providing a clear and stable migration path to fully digital, IP-based solutions. This allows you to move to IP video at your own pace – all at once or one camera at a time. And since all AutoDome modules are completely interchangeable, there is no need to replace expensive components (for example cameras) or labor-intensive components (for example mounts and housings).

### Functions

The following are some of the features that make the AutoDome 200 Series the most flexible PTZ dome camera systems in the security industry.

#### High-performance 18x PTZ color camera

AutoDome 200 Series PTZ color cameras have a 1/4-inch color CCD. With 470 TVL/480 TVL (NTSC/PAL) horizontal resolution and sensitivity down to 0.5 lux, the 200 Series offers exceptional performance at an affordable price. A rugged motor with fewer moving parts mean the 200 Series uses less power and is extremely reliable, making it ideal for high-usage applications.

With super-quick, 360° per-second pan and tilt speeds, the AutoDome 200 Series outperforms other domes in its class. As with all AutoDome Modular PTZ Camera Systems, the 200 Series includes AutoScaling (proportional zoom) and AutoPivot (automatically rotates and flips the camera), so tracking a subject is effortless. The 200 Series supports 64 pre-positions and a single preset tour. The preset tour has the capacity for up to 64 pre-positions with a configurable dwell time between pre-positions.

Supported menu languages include: English, French, German, Spanish, Portuguese, Italian, Dutch, and Polish.

#### Optional hybrid analog/IP operation

AutoDomes equipped with the optional TCP/IP Communications Module use an advanced H.264 encoder to create DVD-quality streaming video across a local or a wide area network, and can simultaneously stream CVBS video via coaxial cabling to support existing analog equipment. Network video streams are sent over IP networks and can be viewed with the Bosch Divar XF Digital Video Recorder, or on a PC running VIDOS video management software. Alternatively, a Bosch IP video decoder can be used to display the video on an analog CVBS or VGA monitor. For maximum accessibility, the video can be viewed using a web browser.

#### Tri-streaming video

Bosch's innovative tri-streaming feature enables AutoDomes equipped with the optional IP Communications Module to generate independent streams simultaneously. This feature allows you to stream high-quality images for live viewing while recording at a reduced frame rate, and at the same time, stream images to a remote PDA device.

#### Unsurpassed reliability

All housings feature recessed screws and latches for increased tamper resistance.

AutoDome pendant housings (indoor and outdoor) are rated to provide IP 66 protection. In addition, the pendant housings come equipped with a low-impact, high-resolution acrylic bubble for enhanced image clarity.

AutoDome in-ceiling housings are rated IK 8 (IEC 62262). These housings feature an impact-resistant polycarbonate Rugged Bubble to protect your camera from vandalism. The Rugged Bubble can withstand impacts equivalent to a 4.5 kg (10 lb) weight dropped from a height of 3 m (10 ft). Outdoor EnviroDome housings provide an operating temperature range down to -40°C (-40°F). The optional "XT" extreme temperature kit allows an AutoDome to operate in temperatures down to -60°C (-76°F), ensuring reliable operation in even the harshest environments.

The Pressurized Environmental Housing is rated to provide IP 67 protection for a VG4 Series AutoDome® Modular Camera System from the elements, both natural and manmade. It is the ideal surveillance solution for applications that require frequent wash-down, including traffic, transit, bridges, tunnels and coastal installations where salt, moisture, dust, insects and fumes threaten the long-term operation of the camera.

#### Ease of installation and servicing

Bosch's innovative software, the Configuration Tool for Imaging Devices (CTFID), allows operators or technicians to control the PTZ, change camera settings and even update firmware from virtually anywhere without need for additional wiring. For the new Ethernet versions, an embedded Web server lets the installer access all the user settings, make camera adjustments, and update firmware via a standard Web browser.

The AutoDome's innovative design simplifies installation and servicing. AutoDome reduces maintenance costs because you can replace individual modules instead of entire camera assemblies. Simply pop out the old module and slide in the new: it's almost as easy as changing a light bulb. All tethers have been replaced with hinges, making installation and servicing safer and easier. You can even access the built-in power supply without taking down the dome.

The AutoDome 200 Series has advanced, built-in diagnostics to simplify service and minimize downtime. Using the On Screen Display (OSD), a technician can quickly and easily check critical parameters (such as internal temperature and input voltage level) to verify that the dome is functioning within acceptable operating limits. If video is not present, a local inspection of three diagnostic LEDs at the camera site can identify the presence of video and control data.

**Feature Comparison Matrix**

The following table provides an overview of the AutoDome camera family and its available features:

Standard Features	AutoDome 100 Series	AutoDome 200 Series	AutoDome 300 Series	AutoDome 500 Series
<b>Interchangeable Modules</b>	•	•	•	•
High Speed PTZ	•	•	•	•
Preset Shots		64	99	99
Preset Tour		•	•	•
Guard Tour		•	•	•
<b>Alarm Inputs</b>			7/4	7/4
High Resolution Camera	•	•	•	•
Day/Night Operation	•	•	•	•
IR Sensitive	•	•	•	•
SensUp Extended Sensitivity	•	•	•	•
UTP/Coax Transmission	•	•	•	•
Hybrid Analog/IP Connectivity	•	•	•	•
Blinx Remote Configuration*	•	•	•	•
Cable Compensation	•	•	•	•
Hot-Swap Camera Modules	•	•	•	•
Ruggedized, Vandal-Resistant Enclosure	•	•	•	•
<b>Advanced Features</b>				
AutoTrack III Motion Tracking			•	•
Video Motion Detection			•	•
Image Stabilization			•	•
Privacy Masking and Sector Blanking			•	•
Advanced Alarm Control			•	•

\*Compatible over Coax and UTP transmission only. Remote configuration over IP via web interface.

**Certifications and approvals**

Electromagnetic Compatibility (EMC)	Complies with FCC Part 15, ICES-003, and CE regulations, including EN50130-4 and EN50121-4
Product Safety	Complies with CE regulations, UL, CSA, EN, and IEC Standards

Region	Certification
Europe	CE EMC Directive, Low-Voltage Directive

**Installation/configuration notes**

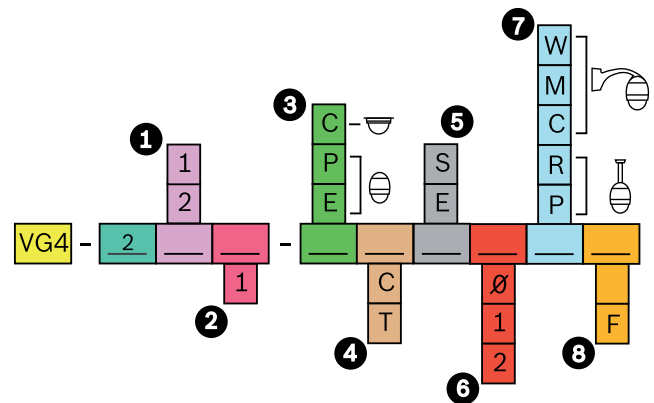

**Ordering Guide**

**1 Video Format**

- 1 PTZ PAL
- 2 PTZ NTSC

**2 Camera Type**

- 1 18x Color PTZ

**3 Enclosure**

- C In-ceiling<sup>2</sup>
- P Indoor Pendant
- E Outdoor Pendant

**4 Bubble**

- C Clear Rugged
- T Tinted Rugged

**5 Communications**

- S Standard Analog (Coax/UTP)
- E Ethernet (TCP/IP)

**6 Power<sup>5</sup>**

- 0 24 VAC<sup>1</sup>
- 1 120 VAC
- 2 230 VAC

**7 Mount**

- W Wall
- M Mast
- C Corner
- R Roof<sup>4</sup>
- P Pipe

**8 Fiber Optics**

- \_ No Fiber
- F Fiber<sup>3</sup>

1 No transformer included. Customer must supply an approved 24 VAC limited power supply (VG4-A-PSUx or equivalent).

2 Recessed in-ceiling housing units do not require kit options for reference numbers 6, 7, or 8.

3 Fiber optic option is multi-mode with biphas. Requires LTC 4629 at the system.

4 Roof mount mounts to vertical Parapet. For flat roof installation, order an additional LTC 9230/01 Flat Roof Adapter Plate.

5 Optional trim skirt available as a separate purchase.

**Technical specifications**

**Camera 18x Color**

Imager	1/4 in. Exview HAD CCD  (752 x 582 PAL)/(768 x 494 NTSC)
Lens	18x Zoom (4.1–73.8 mm) F1.4 to F3.0

Focus	Automatic with manual override	
Iris	Automatic with manual override	
Field of View	2.7° to 48°	
Video Output	1.0 Vp-p, 75 Ohm	
Gain Control	Off/Auto (with adjustable limit)	
Synchronization	Line-Lock (-120° to 120° vertical phase adjust) or internal crystal	
Aperture Correction	Horizontal and vertical	
Horizontal Resolution	NTSC: 470 TVL, typical PAL: 480 TVL, typical	
<b>Sensitivity (typical)</b>	<b>30 IRE</b>	<b>50 IRE</b>
F1.4, 1/60 (1/50) shutter, max AGC	0.5 lx	0.8 lx
Electronic Shutter Speed (AES)	1 to 1/10,000	
SNR	>50 dB	
White Balance	2000 K to 10,000 K	

### Mechanical/Electrical

Model	In-Ceiling	Indoor Pendant	EnviroDome®
Weight	2.66 kg (5.86 lb)	2.88 kg (6.3 lb)	3.32 kg (7.3 lb)
Pan Range	360° cont.	360° cont.	360° cont.
Tilt Angle	1° above horizon	18° above horizon	18° above horizon
Variable Speed	0.1°/s-120°/s	0.1°/s-120°/s	0.1°/s-120°/s
Pre-position Speed	Pan: 360°/s Tilt: 100°/s	Pan: 360°/s Tilt: 100°/s	Pan: 360°/s Tilt: 100°/s
Preset Accuracy	± 0.1° typ.	± 0.1° typ.	± 0.1° typ.
Power	21-30 VAC 50/60 Hz	21-30 VAC 50/60 Hz	21-30 VAC 50/60 Hz

### Power Draw: (typ)

	In-Ceiling	Indoor Pendant	EnviroDome®
Analog Models	10 W	10 W	46 W <sup>6</sup>
Ethernet Models	14 W	14 W	50 W <sup>6</sup>

<sup>6</sup> Add 16 W if using VG4-SHTR-XT kit.

### Surge Suppression

Protection on Video	Peak current 10 kA (Gas Tube Arrester), peak power 1000 W (10/1000 μ)
Protection on RS-232/485, Biphase	Peak current 10 A, peak power 300 W (8/20 μ)

Protection on Alarm Inputs	Peak current 17 A, peak power 300 W (8/20 μ)
Protection on Alarm Outputs	Peak current 2 A, peak power 300 W (8/20 μ)
Protection on Relay Outputs	Peak current 7.3 A, peak power 600 W (10/1000 μ)
Protection on Power Input (Dome)	Peak current 7.3 A, peak power 600 W (10/1000 μ)
Protection on Power Output (Arm Power Supply)	Peak current 21.4 A, peak power 1500 W (10/1000 μ)

### Environmental

Model	In-Ceiling	Indoor Pendant	EnviroDome®
Design Rating	Plenum Rated	IP66	IP66
Operating Temp.	-10°C to 50°C (14°F to 122°F)	-10°C to 50°C (14°F to 122°F)	-40°C to 50°C (-40°F to 122°F)
Storage Temp.	-40°C to 60°C (-40°F to 140°F)	-40°C to 60°C (-40°F to 140°F)	-40°C to 60°C (-40°F to 140°F)
Humidity	0% to 90% relative, non-condensing	0% to 90% relative, non-condensing	0% to 100% relative, condensing

### Miscellaneous

Sectors/Titling	16 independent sectors with 20-character titles/sector
Camera Setup/Control	Biphase, RS-232, RS-485, Bilinx <sup>7</sup> (coax)
Communications Protocols	Biphase, Bilinx <sup>7</sup> , Pelco P, and Pelco D
Pre-positions	64, each with 20-character titles
Preset Tour	One (1), consisting of up to 64 scenes, consecutively
Supported Languages	Czech, Dutch, English, French, German, Italian, Polish, Portuguese, Russian and Spanish

<sup>7</sup> Bilinx not available on Ethernet models.

### User Connections

Power (Camera)	21-30 VAC, 50/60 Hz
Power (Heater)	21-30 VAC, 50/60 Hz
Biphase ±	Control Data
Audio Line In <sup>8</sup>	9 K Ohm typ., 5.5 Vp-p max

RS-232 RX/TX or RS-485  $\pm$  - optional control data  
(dip switch selectable)

Video	BNC/UTP <sup>9</sup>
-------	----------------------

<sup>8</sup> With Ethernet models, the biphase  $\pm$  can optionally be used as the audio line in connector.

<sup>9</sup> Ethernet models have no UTP analog output only BNC (coax).

## Mounts/Accessories

### Pendant Mounts

### Arm Mounts

Wall Arm (No Transformer)	VG4-A-PA0
Wall Arm (120/230 VAC Transformer)	VG4-A-PA1 / VG4-A-PA2
Wall Arm (120/230 VAC Transformer and Fiber Optics)	VG4-A-PA1F / VG4-A-PA2F

### Optional Mounting Plates for Arm Mounts

Corner Mounting Plate	VG4-A-9542
Mast (Pole) Mounting Plate	VG4-A-9541

### Pipe Mounts

Pipe Mount Cap	VG4-A-9543
----------------	------------

### Roof Mounts

Roof (Parapet) Mount	VG4-A-9230
----------------------	------------

### Optional Mounting Plates for Roof Mounts

Flat Roof Adapter for Parapet Mount	LTC 9230/01
-------------------------------------	-------------

### Power Supplies

Outdoor Power Supply Box (120/230 VAC Transformer)	VG4-A-PSU1 / VG4-A-PSU2
Outdoor Power Supply Box (120/230 VAC Transformer and Fiber Optics)	VG4-A-PSU1F / VG4-A-PSU2F
Extended temp heater module extends temperature range to -60°C (-76°F) for EnviroDome® only	VG4-SHTR-XT

## Fiber Optic Models

Optical Fiber Compatibility	50/125 mm, 62.5/125 mm, low loss multimode glass fiber, rated for a minimum system bandwidth of 20 MHz (video 850 nm/Control 1300 nm)
Max Distance	4 km (2.5 miles)

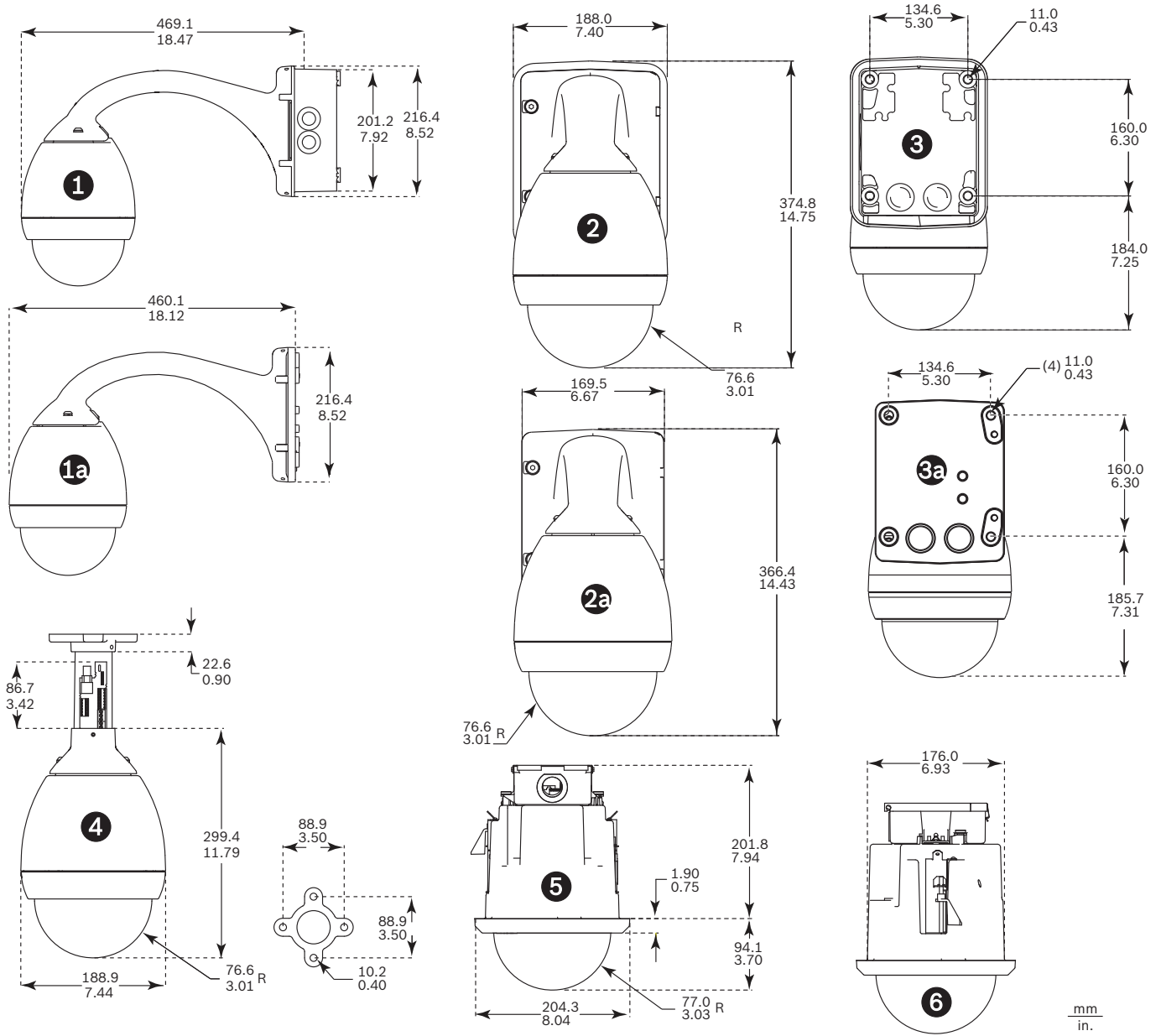

Indoor System Dimensions

Reference	Description
1	Wall Mount – Side with power supply and trim skirt removed
1a	Wall/Mast Mount - Side with VG4-ARMPATE
2	Wall Mount – Front with power supply and trim skirt
2a	Wall Mount – Front with power supply
3	Wall Mount – Back with power supply and trim skirt
3a	Wall Mount – Back with power supply
4	Pipe Mount
5	In-ceiling Mount – Front
6	In-ceiling Mount – Side

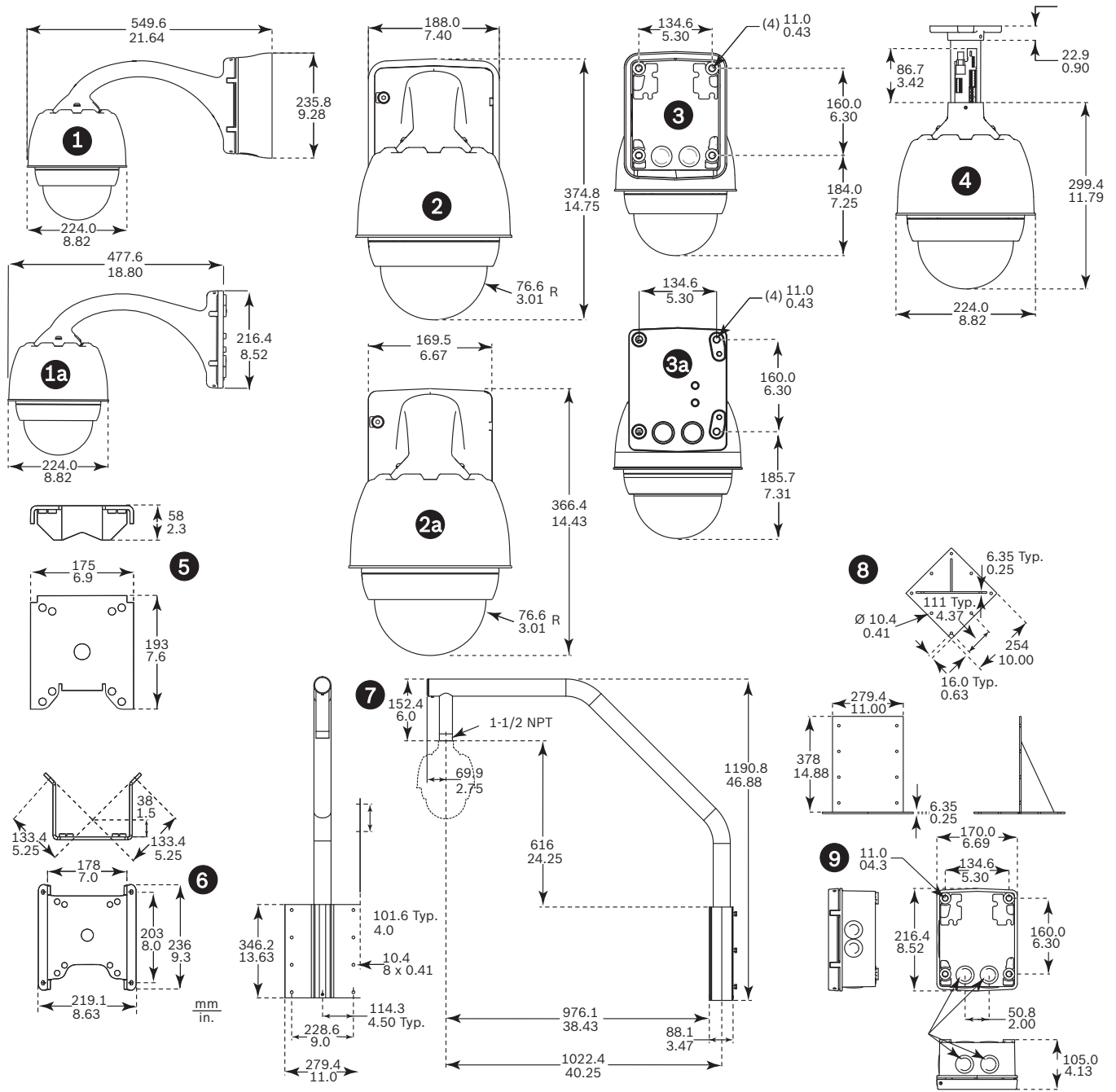

Outdoor System Dimensions

Reference	Description
1	Wall Mount – Side with power supply and trim skirt
1a	Wall/Mast Mount – Side with VG4-ARMPATE
2	Wall Mount – Front with power supply and trim skirt
2a	Wall Mount – Front with power supply
3	Wall Mount – Back with power supply and trim skirt
3a	Wall Mount – Back with power supply
4	Pipe Mount
5	Mast Mount
6	Corner Mount
7	Roof Mount
8	Roof Mount Adapter
9	Power Supply for Pipe and Roof Mounts

**Ordering information**

**VG4211PTS AutoDome 200 Series PTZ Color Analog**  
 PAL, 18x, indoor, tinted dome, without wall arm  
 Order number **VG4-211-PTS**



**VG4211PCS AutoDome 200 Series PTZ Color Analog**

PAL, 18x, indoor, clear dome, without wall arm  
Order number **VG4-211-PCS**

**VG4211ETS AutoDome 200 Series PTZ Color Analog**

PAL, 18x, outdoor, tinted dome, without wall arm  
Order number **VG4-211-ETS**

**VG4211ECS AutoDome 200 Series PTZ Color Analog**

PAL, 18x, outdoor, clear dome, without wall arm  
Order number **VG4-211-ECS**

**VG4211CTS AutoDome 200 Series PTZ Color Analog**

PAL, 18x, in ceiling, tinted dome  
Order number **VG4-211-CTS**

**VG4211CCS AutoDome 200 Series PTZ Color Analog**

PAL, 18x, in ceiling, clear dome  
Order number **VG4-211-CCS**

**VG4211PTS0W AutoDome 200 Series PTZ Color Analog**

PAL, 18x, indoor, tinted dome, 24V, wall mounting  
Order number **VG4-211-PTS0W**

**VG4211PCS0W AutoDome 200 Series PTZ Color Analog**

PAL, 18x, indoor, clear dome, 24V, wall mounting  
Order number **VG4-211-PCS0W**

**VG4211ETS0W AutoDome 200 Series PTZ Color Analog**

AutoDome 200 Series PTZ Color Analog  
Order number **VG4-211-ETS0W**

**VG4211ECS0W AutoDome 200 Series PTZ Color Analog**

PAL, 18x, outdoor, clear dome, 24V, wall mounting  
Order number **VG4-211-ECS0W**

**VG4211ETS0R AutoDome 200 Series PTZ Color Analog**

PAL, 18x, outdoor, tinted dome, 24V, roof mounting  
Order number **VG4-211-ETS0R**

**VG4211ECS0R AutoDome 200 Series PTZ Color Analog**

PAL, 18x, outdoor, clear dome, 24V, roof mounting  
Order number **VG4-211-ECS0R**

**VG4211PTS0P AutoDome 200 Series PTZ Color Analog**

PAL, 18x, indoor, tinted dome, 24V, pipe mounting  
Order number **VG4-211-PTS0P**

**VG4211PCS0P AutoDome 200 Series PTZ Color Analog**

PAL, 18x, indoor, clear dome, 24V, pipe mounting  
Order number **VG4-211-PCS0P**

**VG4211ETS0P AutoDome 200 Series PTZ Color Analog**

PAL, 18x, outdoor, tinted dome, 24V, pipe mounting  
Order number **VG4-211-ETS0P**

**VG4211ECS0P AutoDome 200 Series PTZ Color Analog**

PAL, 18x, outdoor, clear dome, 24V, pipe mounting  
Order number **VG4-211-ECS0P**

**VG4211ETS0M AutoDome 200 Series PTZ Color Analog**

PAL, 18x, outdoor, tinted dome, 24V, mast mounting  
Order number **VG4-211-ETS0M**

**VG4211ECS0M AutoDome 200 Series PTZ Color Analog**

PAL, 18x, outdoor, clear dome, 24V, mast mounting  
Order number **VG4-211-ECS0M**

**VG4211ETS0C AutoDome 200 Series PTZ Color Analog**

PAL, 18x, outdoor, tinted dome, 24V, corner mounting  
Order number **VG4-211-ETS0C**

**VG4211ECS0C AutoDome 200 Series PTZ Color Analog**

PAL, 18x, outdoor, clear dome, 24V, corner mounting  
Order number **VG4-211-ECS0C**

**VG4211PTS2W AutoDome 200 Series PTZ Color Analog**

PAL, 18x, indoor, tinted dome, 230V, wall mounting  
Order number **VG4-211-PTS2W**

**VG4211PCS2W AutoDome 200 Series PTZ Color Analog**

PAL, 18x, indoor, clear dome, 230V, wall mounting  
Order number **VG4-211-PCS2W**

**VG4211ETS2W AutoDome 200 Series PTZ Color Analog**

PAL, 18x, outdoor, tinted dome, 230V, wall mounting  
Order number **VG4-211-ETS2W**

**VG4211ECS2W AutoDome 200 Series PTZ Color Analog**

PAL, 18x, outdoor, clear dome, 230V, wall mounting  
Order number **VG4-211-ECS2W**

**VG4211ETS2R AutoDome 200 Series PTZ Color Analog**

PAL, 18x, outdoor, tinted dome, 230V, roof mounting  
Order number **VG4-211-ETS2R**

**VG4211ECS2R AutoDome 200 Series PTZ Color Analog**

PAL, 18x, outdoor, clear dome, 230V, roof mounting  
Order number **VG4-211-ECS2R**

**VG4211ETS2P AutoDome 200 Series PTZ Color Analog**

PAL, 18x, outdoor, tinted dome, 230V, pipe mounting  
Order number **VG4-211-ETS2P**

**VG4211ECS2P AutoDome 200 Series PTZ Color Analog**

PAL, 18x, outdoor, clear dome, 230V, pipe mounting  
Order number **VG4-211-ECS2P**

**VG4211ETS2M AutoDome 200 Series PTZ Color Analog**

PAL, 18x, outdoor, tinted dome, 230V, mast mounting  
Order number **VG4-211-ETS2M**

**VG4211ECS2M AutoDome 200 Series PTZ Color Analog**

PAL, 18x, outdoor, clear dome, 230V, mast mounting  
Order number **VG4-211-ECS2M**

**VG4211ETS2C AutoDome 200 Series PTZ Color Analog**

PAL, 18x, outdoor, tinted dome, 230V, corner mounting  
Order number **VG4-211-ETS2C**

**VG4211ECS2C AutoDome 200 Series PTZ Color Analog**

PAL, 18x, outdoor, clear dome, 230V, corner mounting  
Order number **VG4-211-ECS2C**



**VG4211PTS0WF AutoDome 200 Series PTZ Color Analog**

PAL, 18x, indoor, tinted dome, 24V, wall mounting, optical fiber

Order number **VG4-211-PTS0WF**

**VG4211PCS0WF AutoDome 200 Series PTZ Color Analog**

PAL, 18x, indoor, clear dome, 24V, wall mounting, optical fiber

Order number **VG4-211-PCS0WF**

**VG4211ETS0WF AutoDome 200 Series PTZ Color Analog**

PAL, 18x, outdoor, tinted dome, 24V, wall mounting, optical fiber

Order number **VG4-211-ETS0WF**

**VG4211ECS0WF AutoDome 200 Series PTZ Color Analog**

PAL, 18x, outdoor, clear dome, 24V, wall mounting, optical fiber

Order number **VG4-211-ECS0WF**

**VG4211ETS0RF AutoDome 200 Series PTZ Color Analog**

PAL, 18x, outdoor, tinted dome, 24V, roof mounting, optical fiber

Order number **VG4-211-ETS0RF**

**VG4211ECS0RF AutoDome 200 Series PTZ Color Analog**

PAL, 18x, outdoor, clear dome, 24V, roof mounting, optical fiber

Order number **VG4-211-ECS0RF**

**VG4-211-ETS0PF AutoDome 200 Series PTZ Color Analog**

PAL, 18x, outdoor, tinted dome, 24V, pipe mounting, optical fiber

Order number **VG4-211-ETS0PF**

**VG4211ECS0PF AutoDome 200 Series PTZ Color Analog**

PAL, 18x, outdoor, clear dome, 24V, pipe mounting, optical fiber

Order number **VG4-211-ECS0PF**

**VG4211ETS0MF AutoDome 200 Series PTZ Color Analog**

PAL, 18x, outdoor, tinted dome, 24V, mast mounting, optical fiber

Order number **VG4-211-ETS0MF**

**VG4211ECS0MF AutoDome 200 Series PTZ Color Analog**

PAL, 18x, outdoor, clear dome, 24V, mast mounting, optical fiber

Order number **VG4-211-ECS0MF**

**VG4211ETS0CF AutoDome 200 Series PTZ Color Analog**

PAL, 18x, outdoor, tinted dome, 24V, corner mounting, optical fiber

Order number **VG4-211-ETS0CF**

**VG4211ECS0CF AutoDome 200 Series PTZ Color Analog**

PAL, 18x, outdoor, clear dome, 24V, corner mounting, optical fiber

Order number **VG4-211-ECS0CF**

**VG4211PTS2WF AutoDome 200 Series PTZ Color Analog**

PAL, 18x, indoor, tinted dome, 230V, wall mounting, optical fiber

Order number **VG4-211-PTS2WF**

**VG4211PCS2WF AutoDome 200 Series PTZ Color Analog**

PAL, 18x, indoor, clear dome, 230V, wall mounting, optical fiber

Order number **VG4-211-PCS2WF**

**VG4211ETS2WF AutoDome 200 Series PTZ Color Analog**

PAL, 18x, outdoor, tinted dome, 230V, wall mounting, optical fiber

Order number **VG4-211-ETS2WF**

**VG4211ECS2WF AutoDome 200 Series PTZ Color Analog**

PAL, 18x, outdoor, clear dome, 230V, wall mounting, optical fiber

Order number **VG4-211-ECS2WF**

**VG4211ETS2RF AutoDome 200 Series PTZ Color Analog**

PAL, 18x, outdoor, tinted dome, 230V, roof mounting, optical fiber

Order number **VG4-211-ETS2RF**

**VG4211ECS2RF AutoDome 200 Series PTZ Color Analog**

PAL, 18x, outdoor, clear dome, 230V, roof mounting, optical fiber

Order number **VG4-211-ECS2RF**

**VG4211ETS2PF AutoDome 200 Series PTZ Color Analog**

PAL, 18x, outdoor, tinted dome, 230V, pipe mounting, optical fiber

Order number **VG4-211-ETS2PF**

**VG4211ECS2PF AutoDome 200 Series PTZ Color Analog**

PAL, 18x, outdoor, clear dome, 230V, pipe mounting, optical fiber

Order number **VG4-211-ECS2PF**

**VG4211ETS2MF AutoDome 200 Series PTZ Color Analog**

PAL, 18x, outdoor, tinted dome, 230V, mast mounting, optical fiber

Order number **VG4-211-ETS2MF**

**VG4211ECS2MF AutoDome 200 Series PTZ Color Analog**

PAL, 18x, outdoor, clear dome, 230V, mast mounting, optical fiber

Order number **VG4-211-ECS2MF**

**VG4211ETS2CF AutoDome 200 Series PTZ Color Analog**

PAL, 18x, outdoor, tinted dome, 230V, corner mounting, optical fiber

Order number **VG4-211-ETS2CF**

**VG4211ECS2CF AutoDome 200 Series PTZ Color Analog**

PAL, 18x, outdoor, clear dome, 230V, corner mounting, optical fiber

Order number **VG4-211-ECS2CF**

**VG4211PTE AutoDome 200 Series PTZ Color IP**

PAL, 18x, indoor, tinted dome, TCP/IP, without wall arm

Order number **VG4-211-PTE**

**VG4211PCE AutoDome 200 Series PTZ Color IP**

PAL, 18x, indoor, clear dome, TCP/IP, without wall arm

Order number **VG4-211-PCE**

**VG4211ETE AutoDome 200 Series PTZ Color IP**

PAL, 18x, outdoor, tinted dome, TCP/IP, without wall arm

Order number **VG4-211-ETE**

**VG4211ECE AutoDome 200 Series PTZ Color IP**

PAL, 18x, outdoor, clear dome, TCP/IP, without wall arm

Order number **VG4-211-ECE**

**VG4211CTE AutoDome 200 Series PTZ Color IP**

PAL, 18x, in ceiling, tinted dome, TCP/IP

Order number **VG4-211-CTE**

**VG4211CE AutoDome 200 Series PTZ Color IP**

PAL, 18x, in ceiling, clear dome, TCP/IP

Order number **VG4-211-CCE**

**VG4211PTE0W AutoDome 200 Series PTZ Color IP**

PAL, 18x, indoor, tinted dome, TCP/IP, 24V, wall mounting

Order number **VG4-211-PTE0W**

**VG4211PCE0W AutoDome 200 Series PTZ Color IP**

PAL, 18x, indoor, clear dome, TCP/IP, 24V, wall mounting

Order number **VG4-211-PCE0W**

**VG4211ETE0W AutoDome 200 Series PTZ Color IP**

PAL, 18x, outdoor, tinted dome, TCP/IP, 24V, wall mounting

Order number **VG4-211-ETE0W**

**VG4211ECE0W AutoDome 200 Series PTZ Color IP**

PAL, 18x, outdoor, clear dome, TCP/IP, 24V, wall mounting

Order number **VG4-211-ECE0W**

**VG4211ETE0R AutoDome 200 Series PTZ Color IP**

PAL, 18x, outdoor, tinted dome, TCP/IP, 24V, roof mounting

Order number **VG4-211-ETE0R**

**VG4211ECE0R AutoDome 200 Series PTZ Color IP**

PAL, 18x, outdoor, clear dome, TCP/IP, 24V, roof mounting

Order number **VG4-211-ECE0R**

**VG4211PTE0P AutoDome 200 Series PTZ Color IP**

PAL, 18x, indoor, tinted dome, TCP/IP, 24V, pipe mounting

Order number **VG4-211-PTE0P**

**VG4211PCE0P AutoDome 200 Series PTZ Color IP**

PAL, 18x, indoor, clear dome, TCP/IP, 24V, pipe mounting

Order number **VG4-211-PCE0P**

**VG4211ETE0P AutoDome 200 Series PTZ Color IP**

PAL, 18x, outdoor, tinted dome, TCP/IP, 24V, pipe mounting

Order number **VG4-211-ETE0P**

**VG4211ECE0P AutoDome 200 Series PTZ Color IP**

PAL, 18x, outdoor, clear dome, TCP/IP, 24V, pipe mounting

Order number **VG4-211-ECE0P**

**VG4211ETE0M AutoDome 200 Series PTZ Color IP**

PAL, 18x, outdoor, tinted dome, TCP/IP, 24V, mast mounting

Order number **VG4-211-ETE0M**

**VG4211ECE0M AutoDome 200 Series PTZ Color IP**

PAL, 18x, outdoor, clear dome, TCP/IP, 24V, mast mounting

Order number **VG4-211-ECE0M**

**VG4211ETE0C AutoDome 200 Series PTZ Color IP**

PAL, 18x, outdoor, tinted dome, TCP/IP, 24V, corner mounting

Order number **VG4-211-ETE0C**

**VG4211ECE0C AutoDome 200 Series PTZ Color IP**

PAL, 18x, outdoor, clear dome, TCP/IP, 24V, corner mounting

Order number **VG4-211-ECE0C**

**VG4211PTE2W AutoDome 200 Series PTZ Color IP**

PAL, 18x, indoor, tinted dome, TCP/IP, 230V, wall mounting

Order number **VG4-211-PTE2W**

**VG4211PCE2W AutoDome 200 Series PTZ Color IP**

PAL, 18x, indoor, clear dome, TCP/IP, 230V, wall mounting

Order number **VG4-211-PCE2W**

**VG4211ETE2W AutoDome 200 Series PTZ Color IP**

PAL, 18x, outdoor, tinted dome, TCP/IP, 230V, wall mounting

Order number **VG4-211-ETE2W**

**VG4211ECE2W AutoDome 200 Series PTZ Color IP**

PAL, 18x, outdoor, clear dome, TCP/IP, 230V, wall mounting

Order number **VG4-211-ECE2W**

**VG4211ETE2R AutoDome 200 Series PTZ Color IP**

PAL, 18x, outdoor, tinted dome, TCP/IP, 230V, roof mounting

Order number **VG4-211-ETE2R**

**VG4211ECE2R AutoDome 200 Series PTZ Color IP**

PAL, 18x, outdoor, clear dome, TCP/IP, 230V, roof mounting

Order number **VG4-211-ECE2R**

---

**VG4211ETE2P AutoDome 200 Series PTZ Color IP**

PAL, 18x, outdoor, tinted dome, TCP/IP, 230V, pipe mounting

Order number **VG4-211-ETE2P**

---

**VG4211ECE2P AutoDome 200 Series PTZ Color IP**

PAL, 18x, outdoor, clear dome, TCP/IP, 230V, pipe mounting

Order number **VG4-211-ECE2P**

---

**VG4211ETE2M AutoDome 200 Series PTZ Color IP**

PAL, 18x, outdoor, tinted dome, TCP/IP, 230V, mast mounting

Order number **VG4-211-ETE2M**

---

**VG4211ECE2M AutoDome 200 Series PTZ Color IP**

PAL, 18x, outdoor, clear dome, TCP/IP, 230V, mast mounting

Order number **VG4-211-ECE2M**

---

**VG4211ETE2C AutoDome 200 Series PTZ Color IP**

PAL, 18x, outdoor, tinted dome, TCP/IP, 230V, corner mounting

Order number **VG4-211-ETE2C**

---

**VG4211ECE2C AutoDome 200 Series PTZ Color IP**

PAL, 18x, outdoor, clear dome, TCP/IP, 230V, corner mounting

Order number **VG4-211-ECE2C**

---

**Software Options**

**VP-CFGSFT Configuration Tool for Imaging Devices**

Camera configuration software for use with Bilinx cameras

Order number **VP-CFGSFT**

---

**Represented by:**

**Americas:**

Bosch Security Systems, Inc.  
130 Perinton Parkway  
Fairport, New York, 14450, USA  
Phone: +1 800 289 0096  
Fax: +1 585 223 9180  
security.sales@us.bosch.com  
www.boschsecurity.us

**Europe, Middle East, Africa:**

Bosch Security Systems B.V.  
P.O. Box 80002  
5617 BA Eindhoven, The Netherlands  
Phone: + 31 40 2577 284  
Fax: +31 40 2577 330  
emea.securitysystems@bosch.com  
www.boschsecurity.com

**Asia-Pacific:**

Robert Bosch (SEA) Pte Ltd, Security Systems  
11 Bishan Street 21  
Singapore 573943  
Phone: +65 6571 2808  
Fax: +65 6571 2699  
apr.securitysystems@bosch.com  
www.boschsecurity.asia

**China:**

Bosch (Shanghai) Security Systems Ltd.  
201 Building, No. 333 Fuquan Road  
North IBP  
Changning District, Shanghai  
200335 China  
Phone +86 21 22181111  
Fax: +86 21 22182398  
www.boschsecurity.com.cn

**America Latina:**

Robert Bosch Ltda Security Systems Division  
Via Anhanguera, Km 98  
CEP 13065-900  
Campinas, Sao Paulo, Brazil  
Phone: +55 19 2103 2860  
Fax: +55 19 2103 2862  
latam.boschsecurity@bosch.com  
www.boschsecurity.com